

**sapa:**

**buildingsystem**

ARCHITECTURAL ALUMINIUM SOLUTIONS

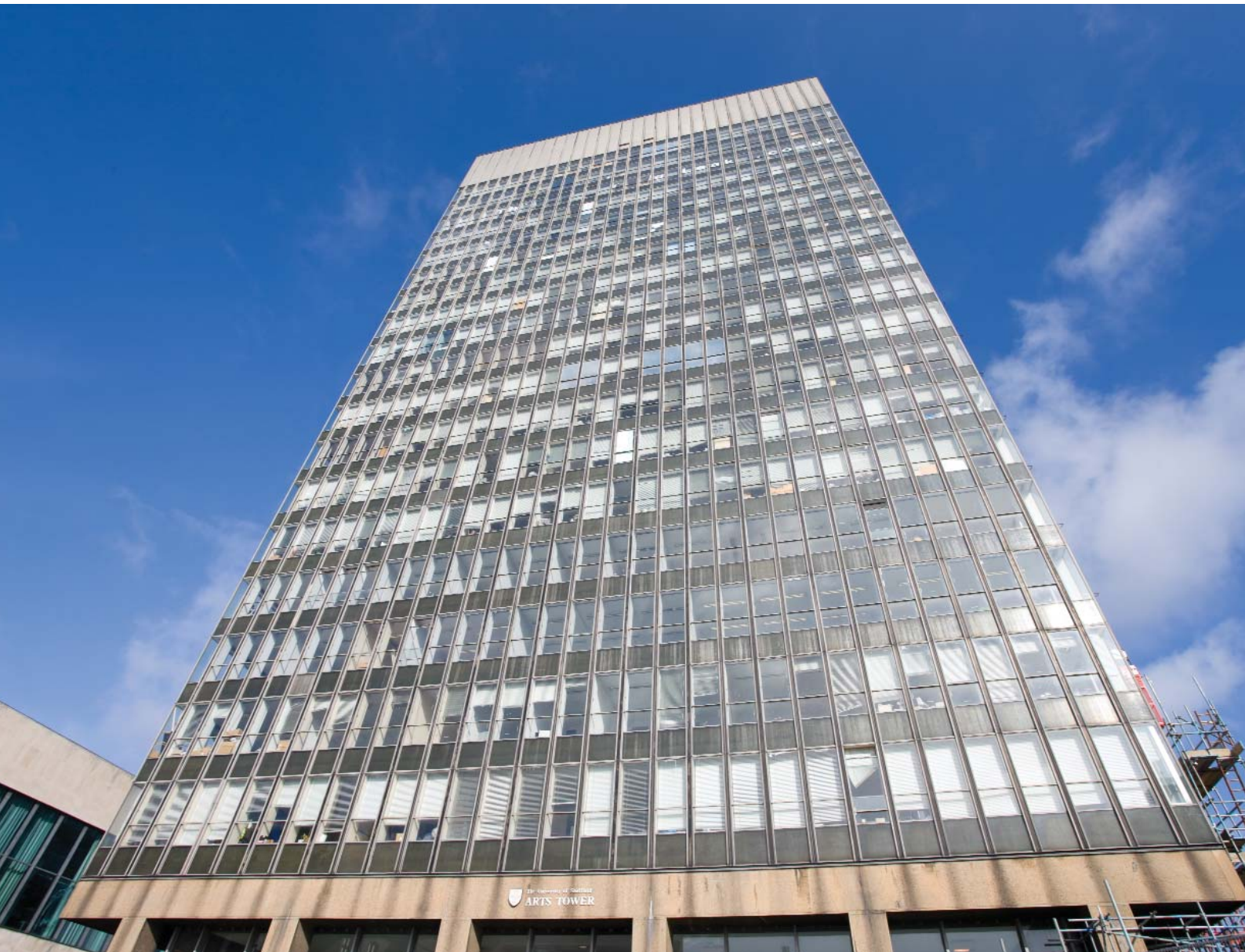

# Dualslide

Vertical and Horizontal Sliding Window System

**Sapa Building System**

# Dualslide

## Vertical & Horizontal Sliding Windows

NEW

High

Performance

Window

Suite

Dualslide is the new solution to vertical and horizontal sliding windows. Utilising advanced polyamide thermal break technology, Dualslide provides high thermal performance without the need to resort to foam filled profiles or complex and costly sealed unit specifications.

Drawing from the tried and tested design principles of Dualframe, Dualslide offers specifiers, contractors and fabricators an unrivalled choice of configurations. Vertical and Horizontal sliding and inward tilting Vertical sliding windows can be combined along with fixed lights to produce glazed facades.

Dualslide provides the opportunity to specify dual colour, where aesthetic choice is paramount.

Spring loaded spiral balances support the vertical sliding sashes, whilst steel rollers housed in a moulded nylon casing enable horizontal sliding panes to operate smoothly. Trickle vents can be fitted to the head of the vertical slider and through the top rail of horizontal sliding windows. Sliding sashes are secured using a concealed stainless steel hook catch. An optional removable turn knob is available for ligature resistant installations such as healthcare.

NEW

### Key Product Features

- Vertical sliding windows can be up to 1500mm wide x 2700mm high and can achieve a weight of 43kg per pane
- Horizontal sliding windows can be up to 3100mm wide x 1500mm high and achieve a weight of 40kg per pane
- Innovative locking mechanism with standard, keyed or anti ligature options
- Insulating glass units of 24mm, 28mm and 32mm can be accommodated within the frames
- Integral finger pulls are extruded into the sash profiles
- Inward tilting vertical sliding sash option to allow cleaning from the inside
- Stainless steel restrictor arm safely limits opening of inward tilt facility (vertical tilt option)
- Beaded sashes means that windows can be re-glazed on site
- Optional die cast zinc pull ring can be added to the top rails for high level operation (vertical sliding)
- Optional key lockable restrictor for tilt vertical slider and horizontal slider, limiting combined movement of sashes to 100mm
- Optional Allen key operated restrictor for straight vertical slider, limiting movement of lower sash to 100mm
- 1.8 u Value can be achieved using a standard spacer in double glazed units\*
- 1.7 u Value can be achieved using warm edge technology in double glazed units
- WER "C" Rating can be achieved using double glazed units

\* Based on standard BFRC window configurations (lower u values are possible for alternative configurations)

Thermal  
Performance

# Weather Performance

	Vertical Slider (Tilt In)	Vertical Slider (Straight)	Horizontal Slider
Water Tightness	Class 7A (300 pa)	Class 9A (600 pa)	Class 5A (200 pa)
Air Permeability	Class 3 (600 pa)	Class 3 (600 pa)	Class 2 (300 pa)
Wind Resistance	Class A5 (2000 pa)	Class AE (2200 pa)	Class A5 (2000 pa)
Exposure Category**	2000	2200	2000

\*\* Exposure category varies with width/height of the window. An accurate figure for wind load can be obtained using BS6399:Part 2 calculations and inertia values

## Key Fabrication Benefits

- All profiles are 5m bar length for improved optimisation
- Beaded glazing, with sealed unit thicknesses up to 32mm
- Dual or single colour finishes are available
- Frame members are square cut and joints are secured using stainless steel fixings into concealed extruded screw ports

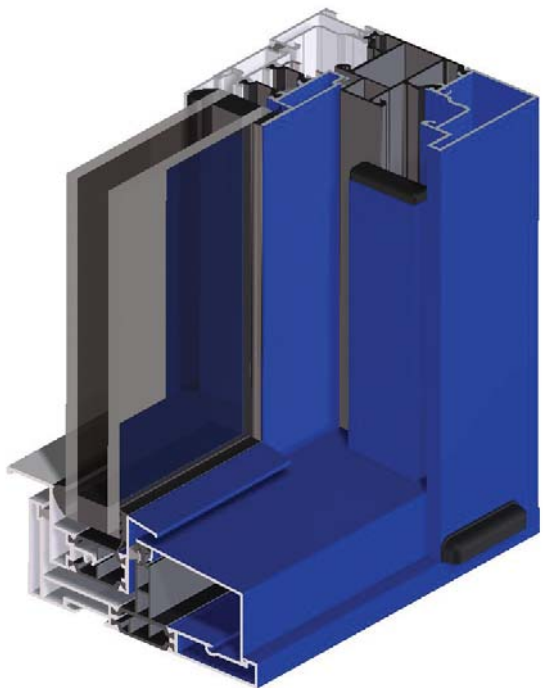

# Vertical Slider General Arrangements

## Upper Jamb

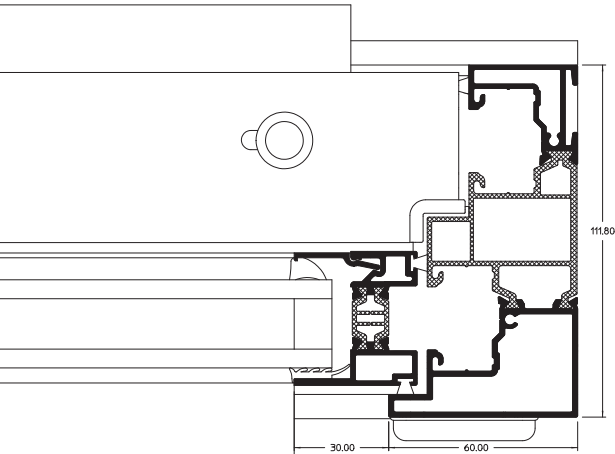

Tilt in vertical slider shown

## Lower Jamb

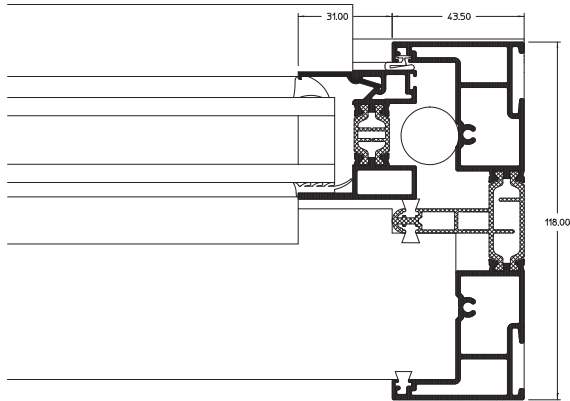

Straight vertical slider shown

## Head

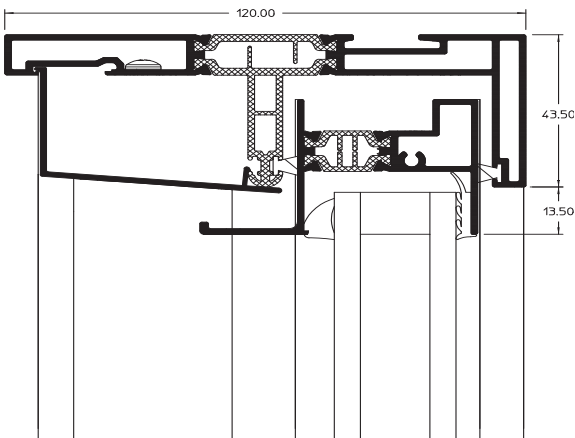

Straight and tilt in vertical slider

## Interlock

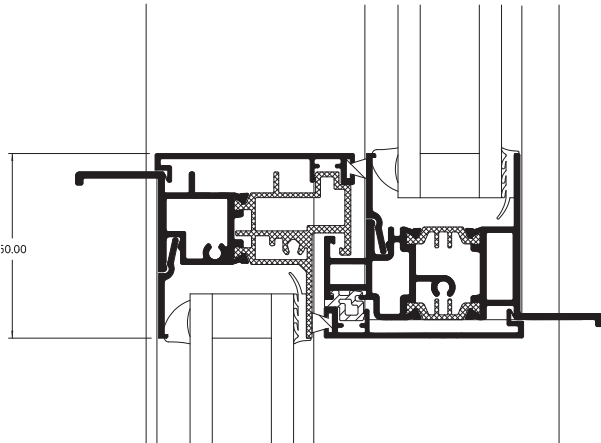

Straight and tilt in vertical slider

## Cill

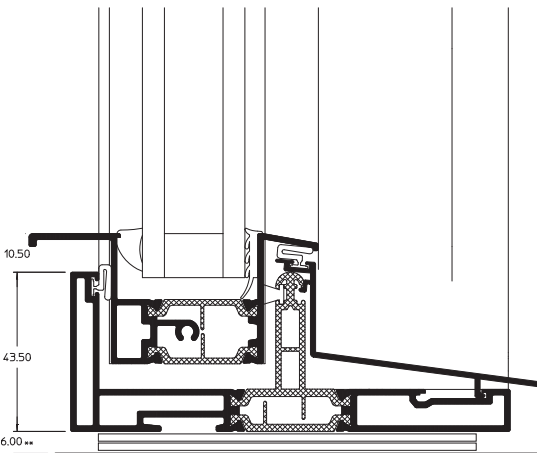

Straight and tilt in vertical slider

# Horizontal Slider General Arrangements

## Head

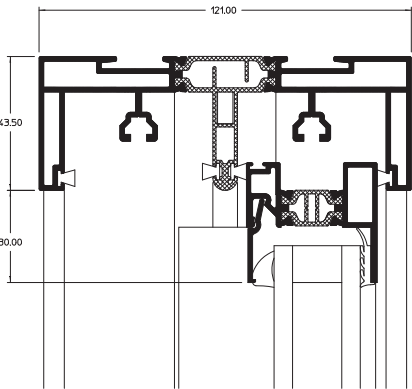

Outer Sliding Sash

## Cill

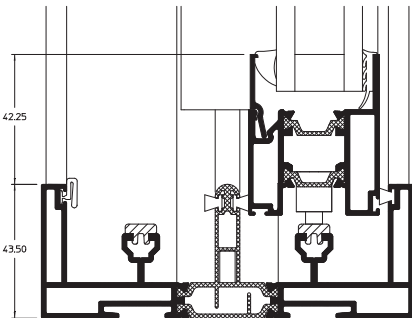

Outer Sliding Sash

## Head

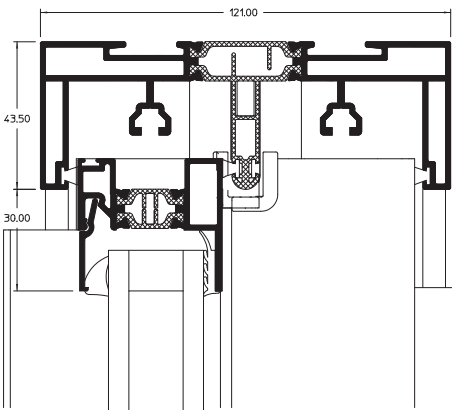

Inner Sliding Sash

## Cill

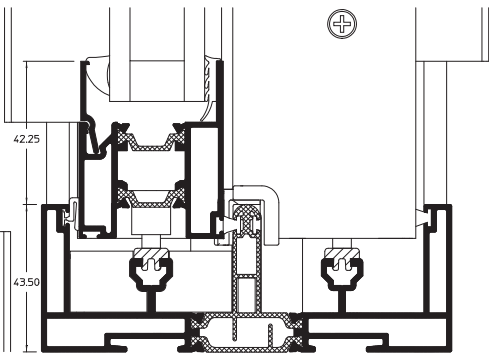

Inner Sliding Sash

## Jamb

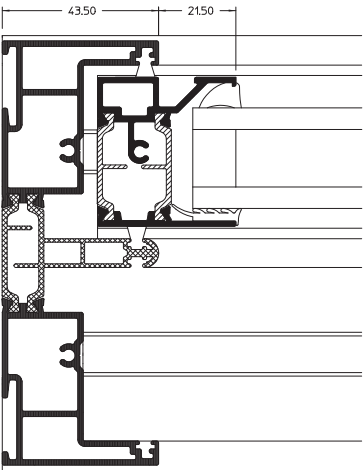





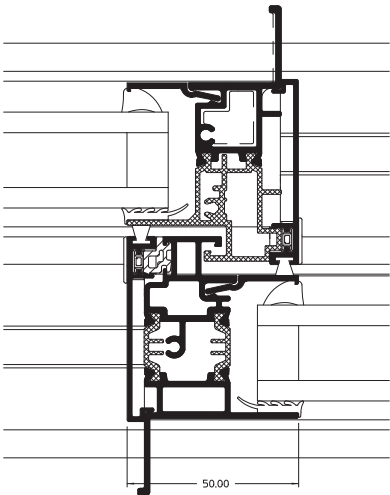







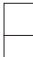

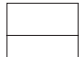







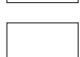

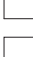
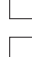
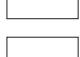

Inner Sliding Sash Shown

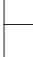
## Interlock

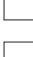
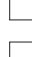

# Size Limitations - Vertical Sliders

	600	900	1200	1500
1100	 ***	 ***	 ***	
1300	 ***	 ***	 ***	 **
1500	 ***	 ***	 **	 **
1700	 ***	 ***	 **	 *
1900	 ***	 **	 **	 *
2100	 ***	 **	 *	
2300	 ***	 **	 *	
2500	 ***	 **	 *	
2700	 ***	 **	 *	

\*\*\* = Spiralift / Ultralift / Torso  
 \*\* = Ultralift / Torso  
 \* = Torso only

## Note

All sizes given are in millimetres.

Sizes shown are to illustrate balance options.

Sash width must not exceed 2.5 times the sash height (see diagram alongside). Windows are supplied with Spiral, Ultralift or Torso balances depending on the sash weight :

Spiralift up to 18.0kg per sash, Ultralift up to 27.0kg per sash, Torso up to 40.0kg per sash. Note that the maximum sash weight for a tilt-in sash is 35kg.

Balance examples alongside are based on 4-16-4 glass construction, with equal sizes. Consideration must be given to any subcill condition that may affect the overall aluminium frame size.



# Size Limitations - Horizontal Sliders

## 2-Pane Slider Kit Size Range

Note : If glazing with two sheets of 6mm (or greater), those units marked '\*' are over 40Kg in weight and are therefore over the maximum sash weight.

	900	1100	1300	1500	1700	1900	2100	2300	
600	<div><div></div><div></div></div>	<div><div></div><div></div></div>	<div><div></div><div></div></div>	<div><div></div><div></div></div>	<div><div></div><div></div></div>	<div><div></div><div></div></div>	<div><div></div><div></div></div>	<div><div></div><div></div></div>	
900	<div><div></div><div></div></div>	<div><div></div><div></div></div>	<div><div></div><div></div></div>	<div><div></div><div></div></div>	<div><div></div><div></div></div>	<div><div></div><div></div></div>	<div><div></div><div></div></div>	<div><div></div><div></div></div>	
1200		<div><div></div><div></div></div>	<div><div></div><div></div></div>	<div><div></div><div></div></div>	<div><div></div><div></div></div>	<div><div></div><div></div></div>	<div><div></div><div></div></div>	<div><div></div><div></div></div>	*
1500			<div><div></div><div></div></div>	<div><div></div><div></div></div>	<div><div></div><div></div></div>	<div><div></div><div></div></div>	<div><div></div><div></div></div>	<div><div></div><div></div></div>	
					*	*	*		

## 3-Pane Slider Kit Size Range

	2100	2300	2500	2700	2900	3100	
600	<div><div></div><div></div><div></div></div>	<div><div></div><div></div><div></div></div>	<div><div></div><div></div><div></div></div>	<div><div></div><div></div><div></div></div>	<div><div></div><div></div><div></div></div>	<div><div></div><div></div><div></div></div>	
900	<div><div></div><div></div><div></div></div>	<div><div></div><div></div><div></div></div>	<div><div></div><div></div><div></div></div>	<div><div></div><div></div><div></div></div>	<div><div></div><div></div><div></div></div>	<div><div></div><div></div><div></div></div>	
1200		<div><div></div><div></div><div></div></div>	<div><div></div><div></div><div></div></div>	<div><div></div><div></div><div></div></div>	<div><div></div><div></div><div></div></div>	<div><div></div><div></div><div></div></div>	
1500			<div><div></div><div></div><div></div></div>	<div><div></div><div></div><div></div></div>	<div><div></div><div></div><div></div></div>	<div><div></div><div></div><div></div></div>	
				*	*	*	



Our policy is one of continuous development and consequently we reserve the right to vary the products and their performance specification shown in this literature without notice. The images shown in this brochure are for illustration purposes only and must not be relied upon for specification. All products and systems which Sapa supply are supplied subject to Sapa's standard Terms and Conditions of Sale.

© Sapa Building Systems Limited

This brochure is issued subject to the condition that it shall not be reproduced without the consent of Sapa Building Systems Limited in writing.

This brochure reference **DFC46 0310**

#### **Sapa Building Systems Ltd**

Postal address **Alexandra Way, Ashchurch, Tewkesbury, Gloucestershire GL20 8NB**

Telephone **01684 853500** Fax **01684 851850**

Email **info@sapabuildingsystems.co.uk** Website **www.sapabuildingsystems.co.uk**

**sapa:**  
**buildingsystem**  
ARCHITECTURAL ALUMINIUM SOLUTIONS